

Recall Identification Guide

At Kidde, the safety of our customers is our priority. We have identified a potential product safety issue related to certain fire extinguishers. As a result, Kidde is voluntarily recalling these extinguishers in the U.S. and Canada.

This guide will help you identify whether your fire extinguisher is included in the recall, and show you where to find the information needed to process your request for a free replacement.

Affected Fire Extinguishers with Plastic Handles

There are two styles of fire extinguishers included in the recall: certain plastic handle fire extinguishers and push-button Pindicator fire extinguishers.

If the extinguisher has a gauge, the first thing to look for is a vertically oriented pull pin that is either fixed with two connections or hanging with a single connection.



Certain affected fire extinguishers also have a straight plastic handle.

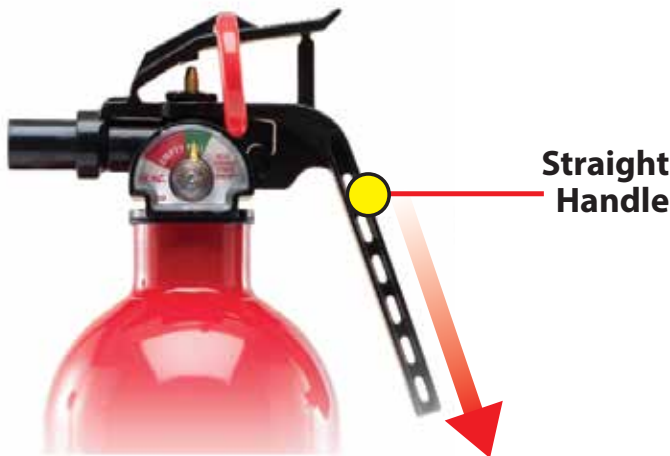

Affected Plastic Handle

RECALLED

RECALLED

Push-Button Pindicator Fire Extinguishers

The other type of affected extinguisher is the push-button Pindicator design. These extinguishers have push buttons, and a T-shaped pull pin and a loop handle. These units come in two sizes and are either red or white.

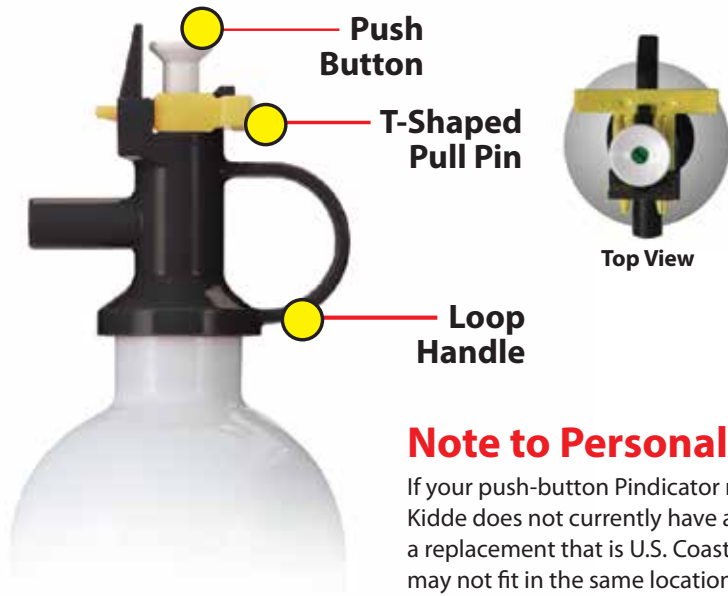

Affected Push-Button Pindicators

Note to Personal Watercraft Owners

If your push-button Pindicator model is used with a personal watercraft, Kidde does not currently have an exact replacement for it, but will provide a replacement that is U.S. Coast Guard rated, and similar in size. While it may not fit in the same location as the extinguisher that you currently have, there may be another space on your watercraft where the extinguisher can be stored or mounted.



NON-AFFECTED

Non-Affected Fire Extinguishers with Metal Handles

If your extinguisher has a metal handle and metal pull pin – in any style – it is not affected.

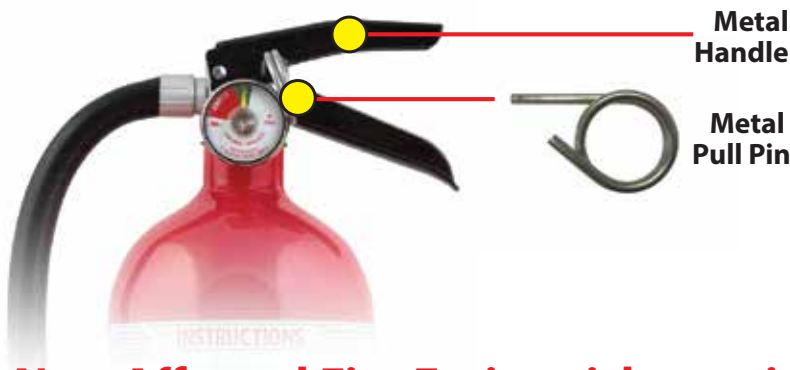

Non-Affected Fire Extinguishers

Non-Affected Fire Extinguishers with Plastic Handles

Plastic handle extinguishers with horizontal plastic pull pins and a curved black plastic handle are also not affected.

These units come in various sizes and are either red, white or silver and can be ABC or BC rated but the important thing to remember is the horizontal plastic pull pin and curved black plastic handle.

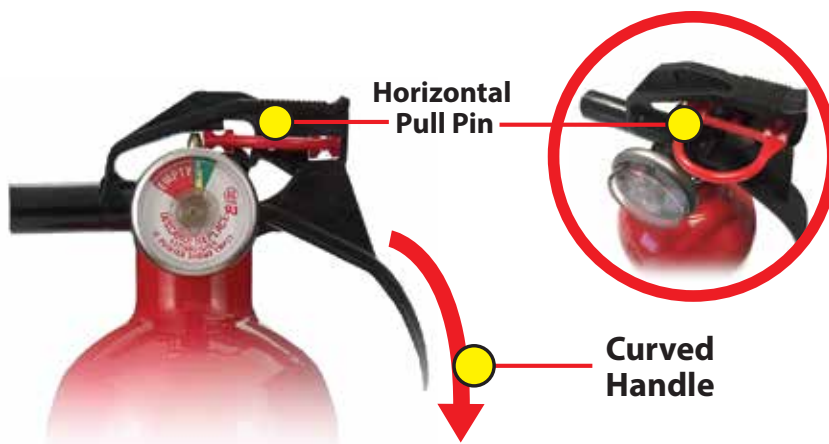

Non-Affected Fire Extinguishers

Requesting a Replacement Fire Extinguisher

To process your replacement for an affected fire extinguisher, you will need to provide three unique identifiers from your unit, the model number, the date of manufacture (if available) and the serial number.

Model Number



First, please locate and identify the model number and color of the fire extinguisher. The model number can be found on the bottom right of the fire extinguisher label, below the UL mark and may consist of both alphabetic characters and numbers.

If more than one model is listed on the label, you will only need to submit the first model listed.

If you are entering your request online, the web form includes a drop down list of affected models and the color of the fire extinguisher – please be sure to select your respective combination of model and color. If you **DO NOT** see your fire extinguisher listed, it is **NOT** subject to the recall.

Date of Manufacture

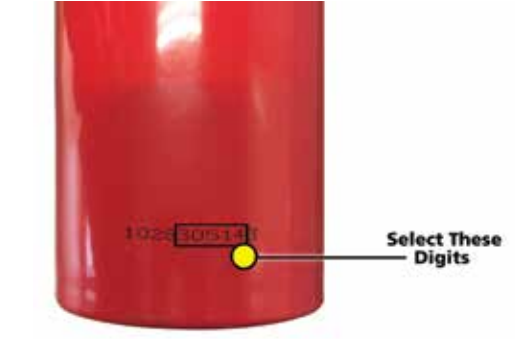

If you are directed by the Kidde representative or the online form to provide the date of manufacture of your fire extinguisher, you can locate this 10-digit date code on the side of the cylinder, near the bottom.

Digits five through nine represent the day and year of manufacture.

1028305143

1 2 3 4 **5 6 7 8 9** 10
You will **ONLY** need to provide these 5 digits.

1028**305143**

1 2 3 4 5 6 7 8 9 10
For units produced before 2007, a date code will not be required.

Serial Number



The final item that you will need to complete your replacement request is the serial number. The serial number is located near the model number on the unit's label and will consist of a combination of both alphabetic characters and numbers.



Consumer Contact: Kidde toll-free at
1-855-271-0773
 from 8 a.m. to 5 p.m. ET Monday through Friday,
 9 a.m. to 3 p.m. ET Saturday and Sunday, or online at www.kidde.com
 and click on Product Safety Notices for more information.

Scan Code with Mobile Device for More Info

